

## 60 cm single door refrigerator H186 cm, freestanding Professional Series

£ 1,099



### **RLD60F4FXNC**

The internal configuration is designed for maximum flexibility thanks to its 389L capacity. This refrigerator has 3 height-adjustable shelves + 1 fixed and 3 humidity-controlled crispers, of which 2 FrescoZero. Interior LED lighting on top and sides provide bright interior illumination on all levels with minimal energy consumption. Its intuitive touch display allows temperature setting, Super Cool, Eco Mode and Drink Cool function activation.

This single door refrigerator is designed to fit seamlessly into any kitchen configuration due to its reversible door.

Using one of the 2 available handle kits in Professional and Master Series style, this refrigerator integrates seamlessly with all other Bertazzoni appliances into style-harmonized suites for a true, high-performing kitchen.

[Guarda online](#)

# Specifications

---

## Features

---

### General features

---

Size	60 cm
Total volume	389 L
Cooling system	no frost
User interface	LED touch control interface
Display functions	Super Cool, Eco Mode, Drink Cool
Lighting	LED lighting
Open door alarm	yes
Door finishing	stainless steel
Door hinges	left or right swing configuration
Refrigerator shelves	3 height-adjustable + 1 stationary
Refrigerator drawers	3 with humidity control, of which 2 FrescoZero
Bins	4 height-adjustable bins + 1 gallon-sized bin

---

### Technical specifications

---

Energy class	E
Voltage and frequency	220-240V, 50 Hz
Absorbed power (W)	110
Annual energy consumption (kWh)	121

---

# Dimensions

## PRODUCT DIMENSIONS

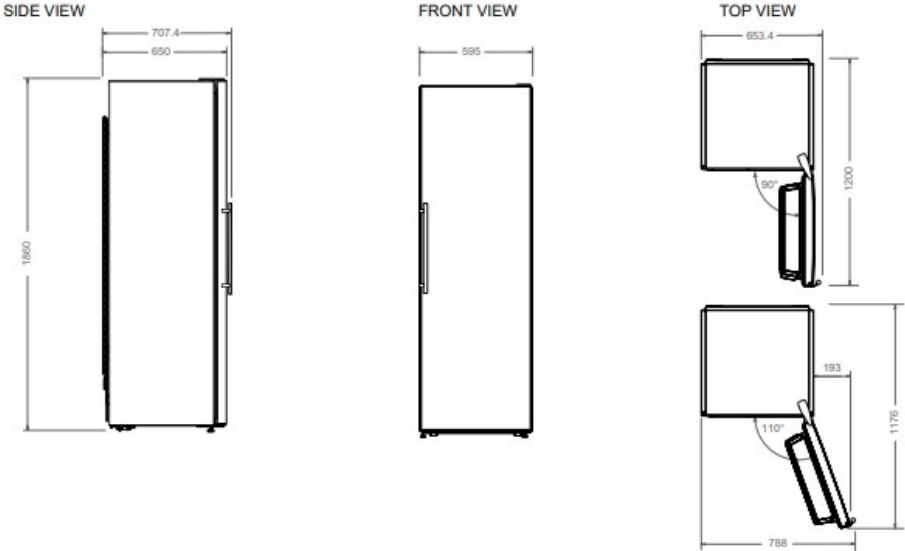

## CUTOUT DIMENSIONS

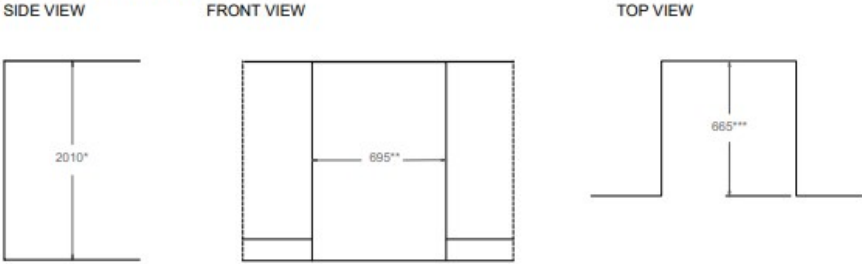

\* dimension with a minimum clearance of 150 mm on top

\*\* dimension with a minimum clearance of 50 mm on both sides

\*\*\* dimension with a minimum clearance of 15 mm on back